



5 Moorland Drive

Plympton, Plymouth, PL7 2BY

£290,000



A well-presented semi-detached family home in a desirable location within Plympton within easy reach of shops, several schools and other local amenities. The accommodation briefly comprises an entrance porch, lounge, kitchen/diner, 3 bedrooms & bathroom. Externally, there is parking for multiple vehicles on the private driveway, a garage, front garden and a sunny south-facing rear garden.



MOORLAND DRIVE, PLYMPTON, PL7 2BY

ACCOMMODATION

uPVC double-glazed door with obscured patterned glass inset leading into the entrance porch.

ENTRANCE PORCH 5'0" x 4'7" (1.53 x 1.42)

Doorway leading into the lounge.

LOUNGE 14'7" x 13'5" (4.47 x 4.09)

2 uPVC double-glazed windows, one to the front elevation and one to the side elevation. Opening leading into the kitchen/diner. Stairs ascending to the first floor accommodation.

KITCHEN/DINER 14'8" x 9'11" (4.49 x 3.03)

Selection of base and wall-mounted units with a square-edged laminate work top. Inset stainless-steel one-&-a-half bowl single drainer sink with a mixer tap. Inset induction hob with a wall-mounted extractor fan over. Integrated electric double oven. Space for a washing machine and a free-standing fridge-freezer. uPVC double-glazed French doors leading out to the rear garden. Doorway opening to the under-stairs storage cupboard. uPVC double-glazed window to the rear elevation.

FIRST FLOOR LANDING 8'2" x 5'10" (2.50 x 1.79)

uPVC double-glazed window to the side elevation. Loft hatch providing access to the loft space. Doors providing access to the first floor accommodation.

BEDROOM ONE 13'0" x 8'5" (3.97 x 2.59)

Built-in wardrobes. uPVC double-glazed window to the front elevation.

BEDROOM TWO 9'3" x 8'7" (2.83 x 2.63)

Built-in wardrobe. uPVC double-glazed window to the rear elevation.

BEDROOM THREE 10'0" max x 5'10" (3.07 max x 1.80)

Built-in cupboard. uPVC double-glazed window to the front elevation.

BATHROOM 5'11" x 5'5" (1.81 x 1.66)

Comprising a 'P-shaped' bath with an electric shower over and a curved shower screen, pedestal sink with a mixer tap and a close coupled wc. Obscured glass uPVC double-glazed window to the rear elevation.

GARAGE 17'4" x 8'11" (5.30 x 2.73)

Located at the top of the driveway. Electric up-&-over door. Power and lighting. uPVC double-glazed window to the rear elevation.

OUTSIDE

The property is approached via a concrete driveway running along the side of the property to a metal gate, providing access to the garden and garage. Adjacent to the driveway is an area of front garden which is laid to lawn together with a small area laid to pebble stones bordered by wooden sleepers. The rear garden is fully enclosed and south-facing. There is a patio area complete with a brick-built barbecue. Steps lead up to an area laid to astro turf and stone chippings bordered by mature trees, shrubs and bushes.

COUNCIL TAX

Plymouth City Council
Council tax band C

WHAT3WORDS

///legal.burns.long

Area Map



Floor Plans

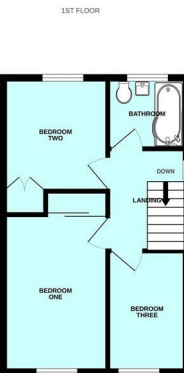
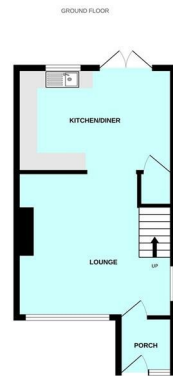

Energy Efficiency Graph

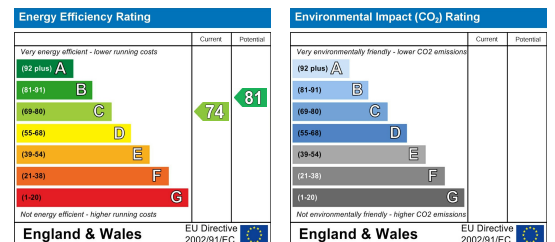

These particulars, whilst believed to be accurate are set out as a general outline only for guidance and do not constitute any part of an offer or contract. Intending purchasers should not rely on them as statements of representation of fact, but must satisfy themselves by inspection or otherwise as to their accuracy. No person in this firm's employment has the authority to make or give any representation or warranty in respect of the property.